

# CLUTCH PEDAL

## CLUTCH PEDAL

PFP:46540

### On-Vehicle Inspection and Adjustment HEIGHT ADJUSTMENT

ACS0014X

1. Check that clutch pedal height  $H_1$  from the melt sheet is within the specified range.

**Pedal height  $H_1$  : 171 - 179 mm (6.73 - 7.05 in)**

2. If pedal height  $H_1$  is outside the specification, loosen ASCD cancel switch lock nut B and turn ASCD cancel switch. next loosen clevis lock nut A and turn push rod to adjust.
3. When pedal height comes into the specified range, tighten ASCD cancel switch lock nut B and clevis lock nut A to the specified torque.

**Lock nut A:**

: **7.8 - 11 N·m (0.80 - 1.1 kg·m, 69 - 97 in·lb)**

**Lock nut B:**

: **12 - 14 N·m (1.3 - 1.4 kg·m, 9 - 10 ft·lb)**

4. Check that free play A at pedal pad top surface and pedal height  $H_2$  when clutch is disengaged are within the specified ranges below.

**Pedal free play (measured at pedal pad) A:**

**9 - 16 mm (0.35 - 0.63 in)**

**Pedal free play (clevis pin free play):**

**1.0 - 3.0 mm (0.04 - 0.12 in)**

**Pedal height  $H_2$  when clutch is disengaged:**

**100 mm (3.94 in) or more**

5. Check that free play A at pedal pad top surface and pedal height  $H_2$  when clutch is disengaged are within the specified ranges below. If it is outside the specification, loosen lock nut A and turn push rod to adjust.

**CAUTION:**

**Threaded end of the push rod must be positioned inside the clevis.**

6. Tighten lock nut A to the specified torque.

**Lock nut A:**

: **7.8 - 11 N·m (0.80 - 1.1 kg·m, 69 - 97 in·lb)**

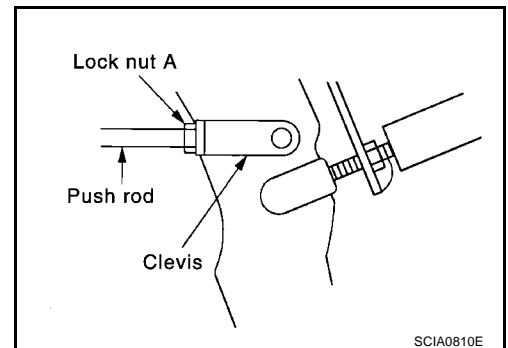
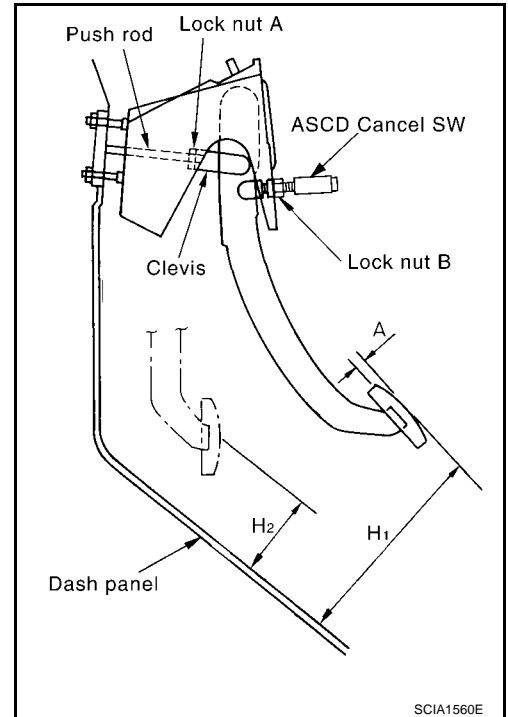

### CLUTCH INTER LOCK SWITCH POSITION ADJUSTMENT

- With the pedal depressed, adjust the switch position so that the distance between the stopper rubber and the clutch inter lock switch screw end is dimension C, and then tighten lock nut D.

**Dimension C: 0.1 - 1.0 mm (0.004 - 0.04 in)**

: **12 - 14 N·m (1.3 - 1.4 kg·m, 9 - 10 ft·lb)**

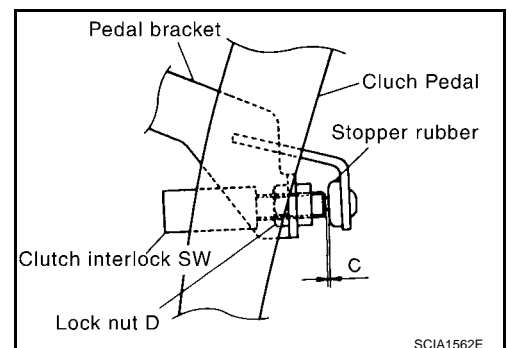

# CLUTCH PEDAL

## FREE PLAY INSPECTION

- Press the clutch pedal by hand until certain push rod is activated can be felt. Using a scale, check that the free play is within the specified range.

**Pedal free play [looseness at clevis pin]:**  
**1.0 - 3.0 mm (0.04 - 0.12 in)**

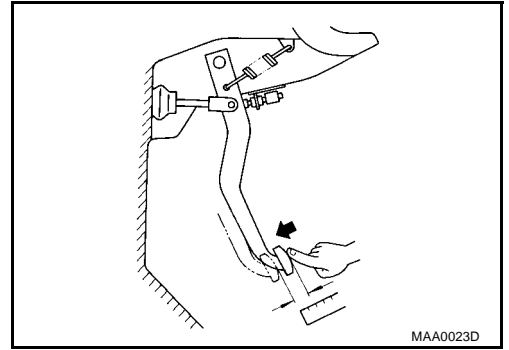

## CLEARANCE CHECK

1. Start the engine and let it idle.
2. Apply parking brake.
3. Depress the brake pedal.
4. Fully depress clutch pedal and shift to 1st gear.
5. Release clutch pedal gradually. Stop releasing the pedal at the point where the clutch is about to be engaged. Using a scale, check the clearance between the clutch pedal and floor panel to see if it is within the specified range.

**Pedal height when the clutch disengages:**  
**100 mm (3.94 in) or more**

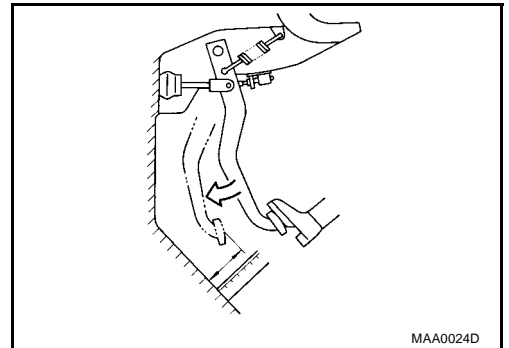

### NOTE:

Pedal height at clutch disengagement varies slightly from the clutch engagement point. Despite this, pedal height at clutch engagement is commonly used for both cases in order to simplify the inspection.

## Removal and Installation

ACS0014Y

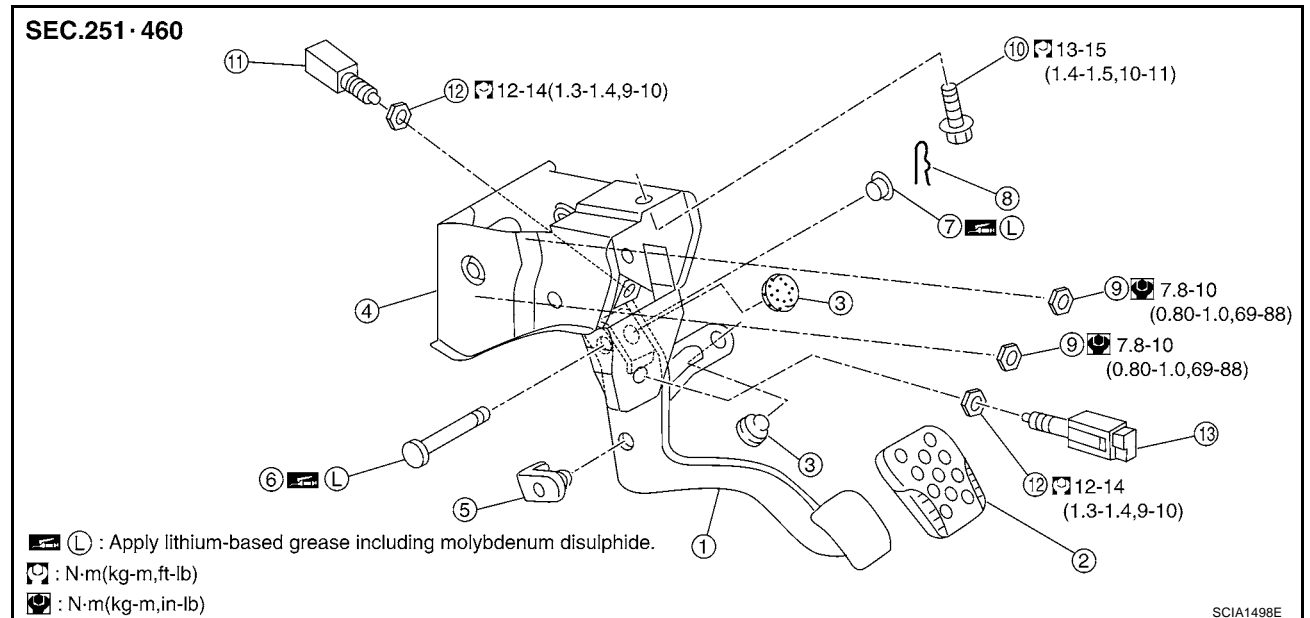

- |                        |                              |                   |
|------------------------|------------------------------|-------------------|
| 1. Clutch pedal        | 2. Pedal pad                 | 3. Stopper rubber |
| 4. Bracket             | 5. Stopper rubber            | 6. Clevis pin     |
| 7. Bushing             | 8. Snap pin                  | 9. Nut            |
| 10. Bolt               | 11. Clutch inter lock switch | 12. Lock nut      |
| 13. ASCD cancel switch |                              |                   |

### NOTE:

Tighten the ASCD cancel switch lock nut to the specified torque after installing the clutch pedal assembly in the vehicle and adjusting the pedal height.