

# FRONT SUSPENSION ASSEMBLY

## Components

AES0002T

SEC.400-401-406

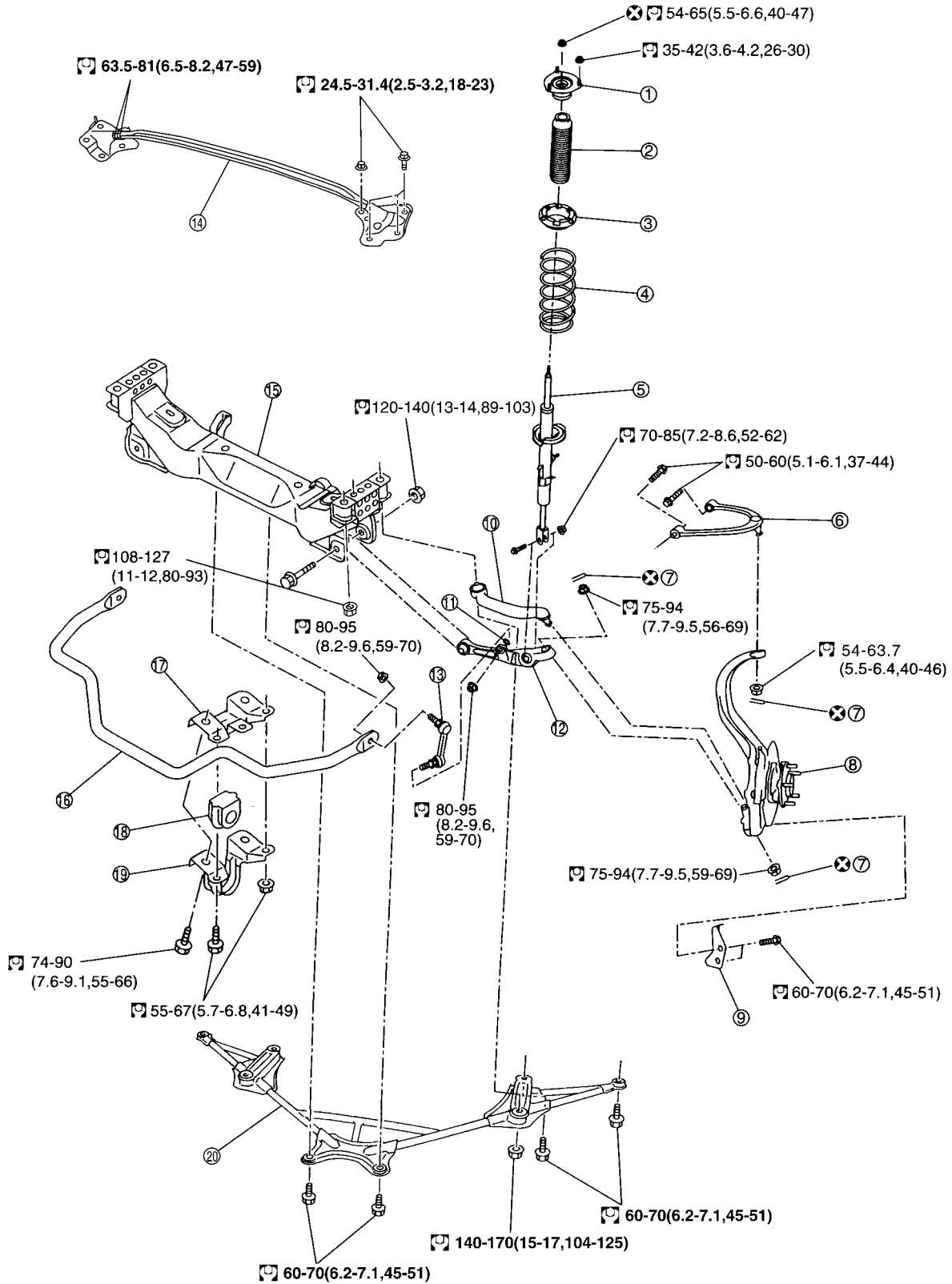

☒ : N·m(kg·m,ft·lb)

☒ : Always replace after disassembly

SEIA0238E

# FRONT SUSPENSION ASSEMBLY

- |                               |                              |                             |
|-------------------------------|------------------------------|-----------------------------|
| 1. Mounting insulator         | 2. Bound bumper              | 3. Spring upper seat        |
| 4. Coil spring                | 5. Shock absorber            | 6. Upper link               |
| 7. Cotter pin                 | 8. Front axle                | 9. Steering stopper bracket |
| 10. Compression rod           | 11. Washer                   | 12. Transverse link         |
| 13. Stabilizer connecting rod | 14. Tower bar                | 15. Front suspension member |
| 16. Stabilizer bar            | 17. Stabilizer clamp bracket | 18. Stabilizer bushing      |
| 19. Stabilizer clamp          | 20. Front cross bar          |                             |

A  
B  
C

## Removal and Installation

AES000DM

### REMOVAL

1. Remove tire with power tool.
2. Remove brake caliper with power tool. Hang it in a place where it will not interfere with work. Refer to [BR-25, "FRONT DISC BRAKE \(CLZ25VD TYPE\)"](#) , [BR-31, "FRONT DISC BRAKE \(OPB27VA TYPE\)"](#) .
3. Remove under cover with power tool.
4. Remove fixing bolts and nuts, then remove front cross bar from vehicle with power tool.
5. Remove steering hydraulic piping bracket from front suspension member. Refer to [PS-34, "HYDRAULIC LINE"](#) .
6. Remove steering gear and front suspension member attachment bolts and hang steering gear on vehicle. Refer to [PS-17, "POWER STEERING GEAR AND LINKAGE"](#) .
7. Set jack under engine.  
**CAUTION:**  
**When setting jack to the engine, use a wooden block or an equivalent for the setting.**
8. Remove fixing bolt and nut between shock absorber and transverse link with power tool.
9. Remove cotter pin of upper link ball joint, and then loosen nut.
10. Use a ball joint remover (suitable tool) to remove upper link from steering knuckle. Be careful not to damage ball joint boot.  
**CAUTION:**  
**To prevent damage to threads and to prevent ball joint remover (suitable tool) from coming off, and temporarily tighten lock nuts.**
11. Remove fixing nut and washer located at the bottom of stabilizer connecting rod, and then remove stabilizer connecting rod from transverse link with power tool.
12. Remove fixing nuts between engine mounting insulator and front suspension member. Refer to [EM-89, "ENGINE ASSEMBLY"](#) .
13. Remove fixing nuts between front suspension member and body with power tool.
14. Remove front suspension assembly from vehicle.

FSU

D  
E  
F  
G  
H  
I  
J  
K  
L

### INSTALLATION

- Refer to [FSU-8, "Components"](#) for tightening torque. Tighten in the reverse order of removal.  
**CAUTION:**  
**Refer to component parts location and do not reuse non-reusable parts.**
- Perform final tightening of shock absorber lower side (rubber bushing) under unladen condition with tires on level ground. Check wheel alignment. Refer to [FSU-21, "SERVICE DATA"](#) .

M